

INSTALLATION INSTRUCTIONS

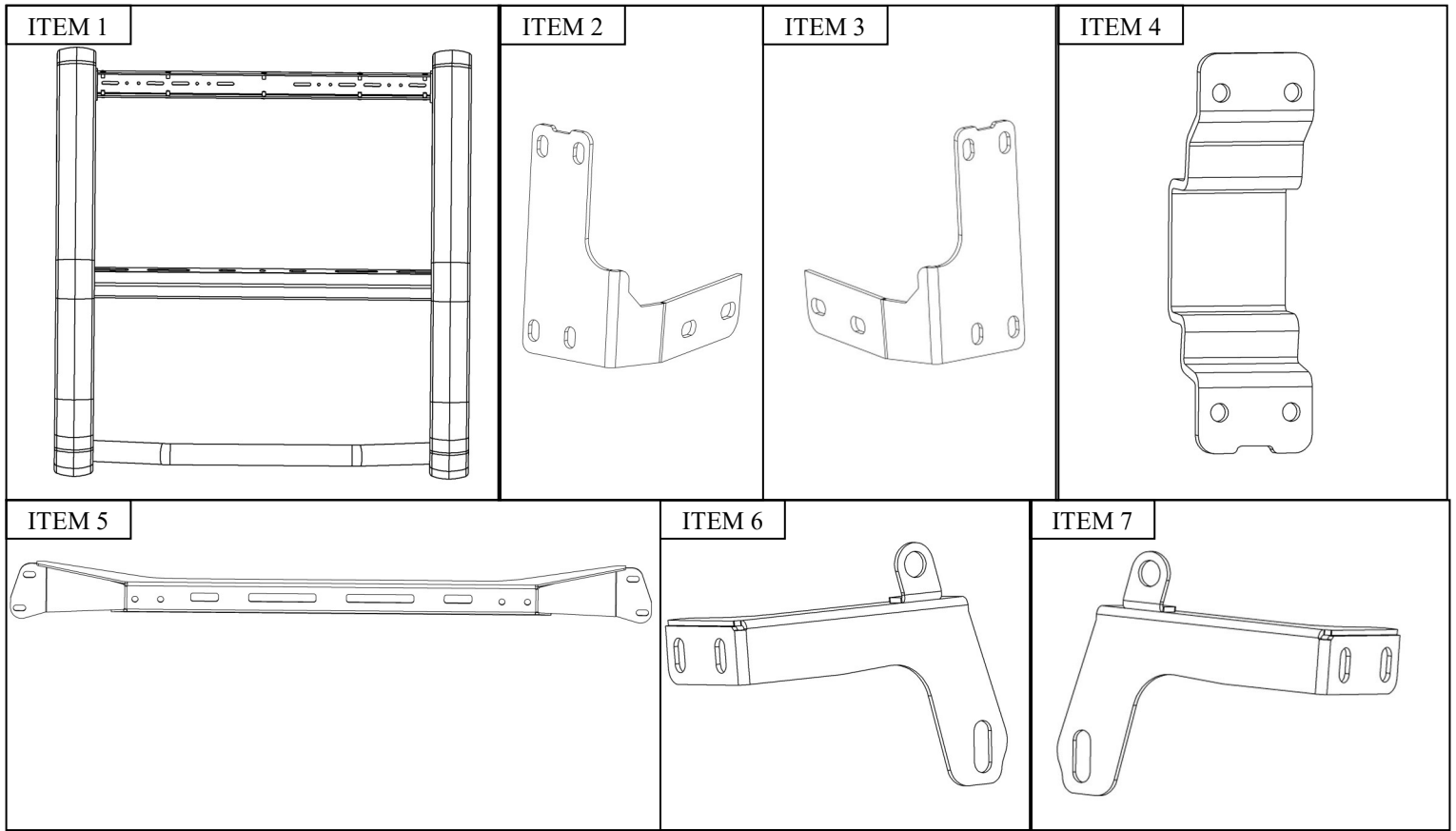

PUSH BUMPER ELITE
APPLICATION:
2020 Dodge Durango
PART NUMBER:
36-4055

CONTENT			
ITEM	QUANTITY	DESCRIPTION	TOOLS NEEDED
1	1	PUSH BUMPER	13MM WRENCH
2	1	DRIVER MOUNTING BRACKET	15MM WRENCH
3	1	PASSENGER MOUNTING BRACKET	17MM WRENCH
4	2	CLAMP BRACKET	TRIM REMOVAL TOOL
5	1	CROSS BAR	RATCHET
6	1	DRIVER SUPPORT STRAP	TORQUE WRENCH
7	1	PASSENGER SUPPORT STRAP	4MM ALLEN
8	2	M10 BUTTON HEAD BOLT	6MM ALLEN
9	2	M10 BELLVILLE WASHER	8MM ALLEN
10	2	M10 FLANGE SERRATED HEX NUT	
11	4	M12 BUTTON HEAD BOLT	
12	4	M12 BELLVILLE WASHER	
13	4	M12 FLANGE SERRATED HEX NUT	
14	12	M8 HEX HEAD BOLT	
15	12	M8 FLAT WASHER	
16	12	M8 LOCK WASHER	
17	2	M6 BUTTON HEAD BOLT	
18	4	M6 FLAT WASHER	
19	2	M6 SERRATED FLANGE NUT	
20	2	M6 LOCK WASHER	
ANTI-SEIZE LUBRICANT MUST BE USED ON ALL STAINLESS STEEL FASTENERS TO PREVENT THREAD DAMAGE AND GALLING			



PROCEDURE

1. Remove contents from box, verify if all parts listed are present and free from damage. Carefully read and understand all instructions before attempting installation. **Failure to identify damage before installation could lead to a rejection of any claim.**

2. Remove the front fascia by removing trim clips and screws as shown in **Figures 1-2.**



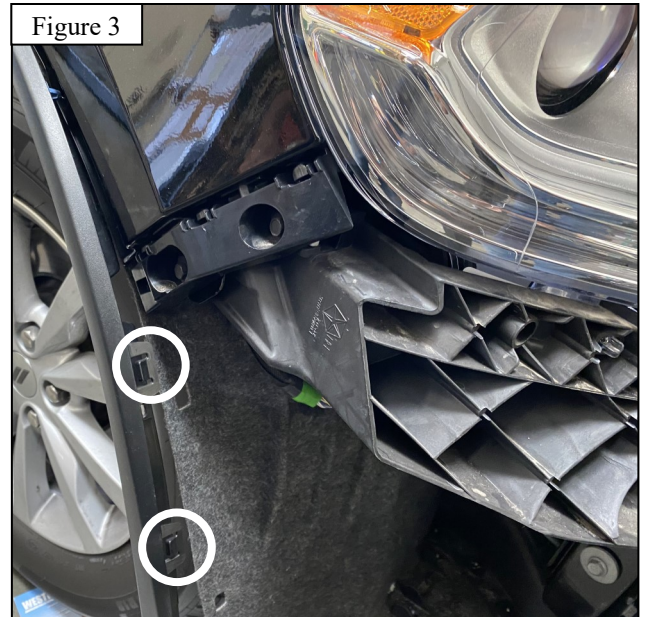

3. Unplug running lights before completely removing the fascia on each side. See Figure 4



4. You will need to trim the fascia in multiple areas using a cutting tool. Remove the grille before cutting . See **Figure 5** for reference.

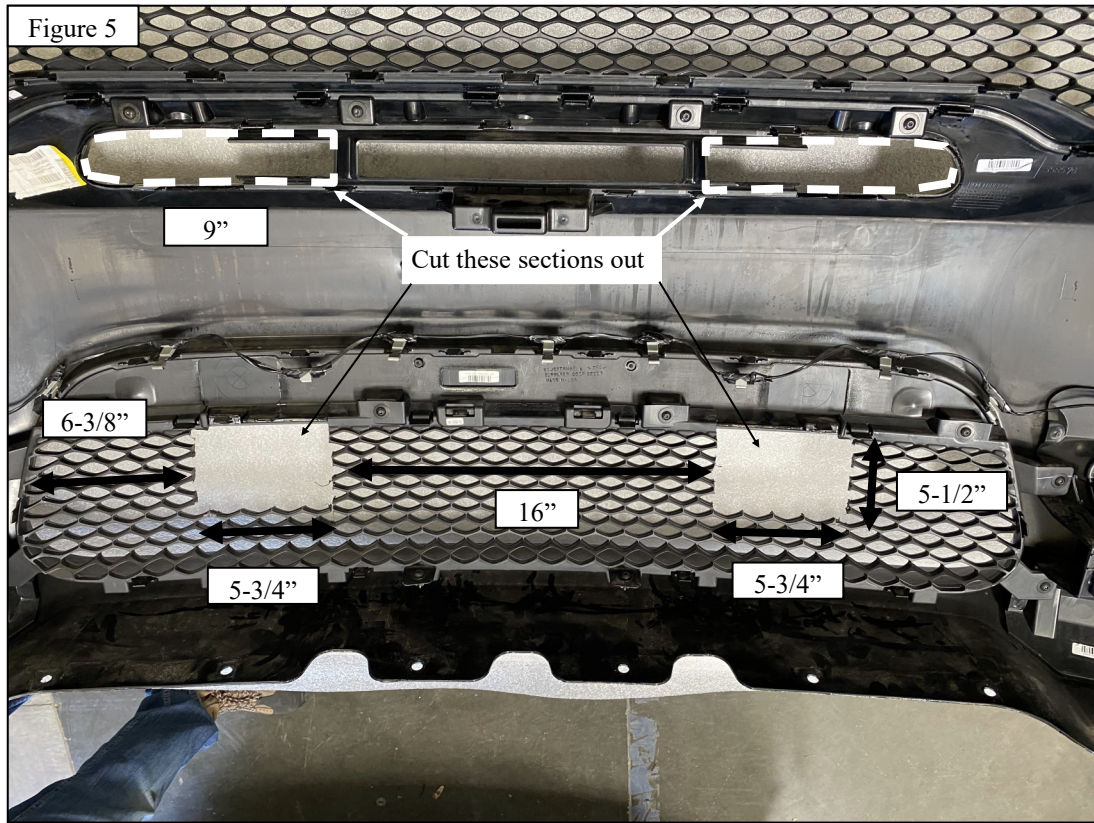

5. Remove the corner radiator shroud on each side. Trim as shown in **Figure 6**
6. Remove the foam piece in the center. You will not reuse this piece. See **Figure 7**

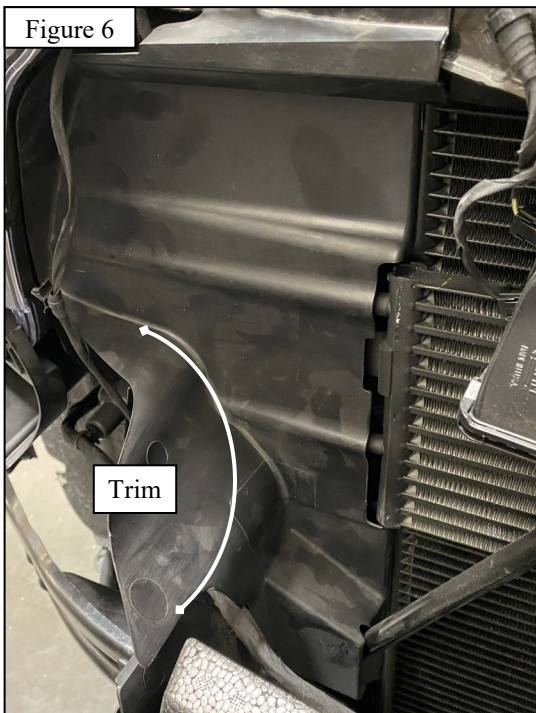

7. Using supplied M8 Hardware, install clamp bracket (4) and mounting brackets (2 & 3). Repeat on the passenger side. See **Figure 8**

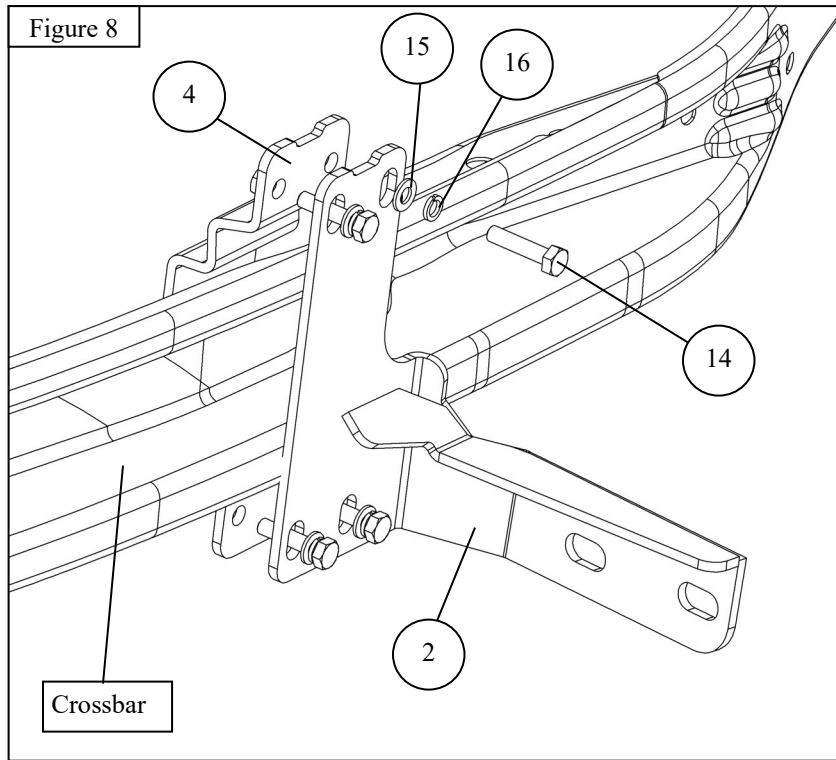

8. Measure the tips of the front mounting brackets. Make sure they are spaced around 25.75" inside between brackets and centered to the vehicle. See **Figure 9**

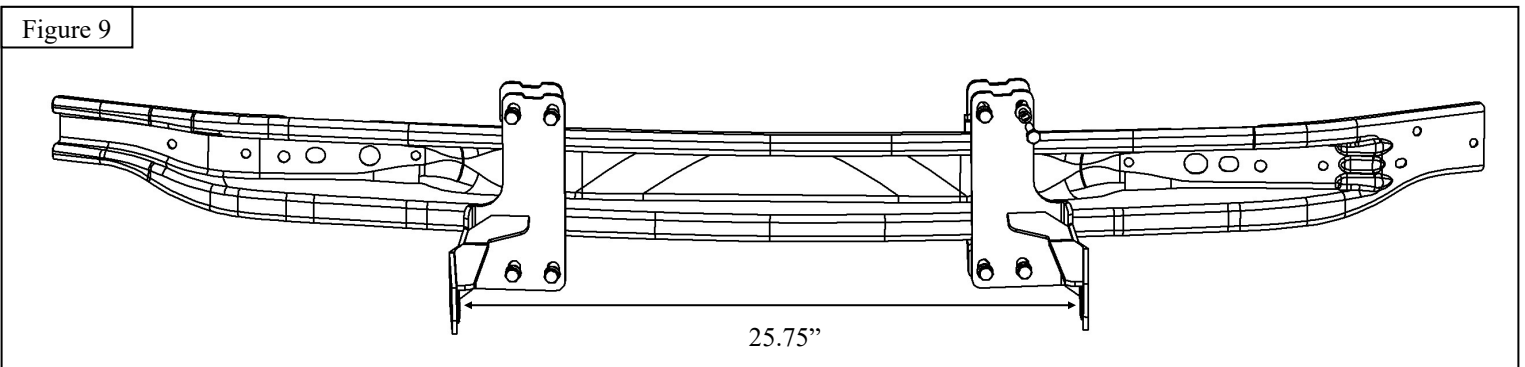

9. Mount the cross bar to the front radiator support re-using factory hardware. See **Figure 10**

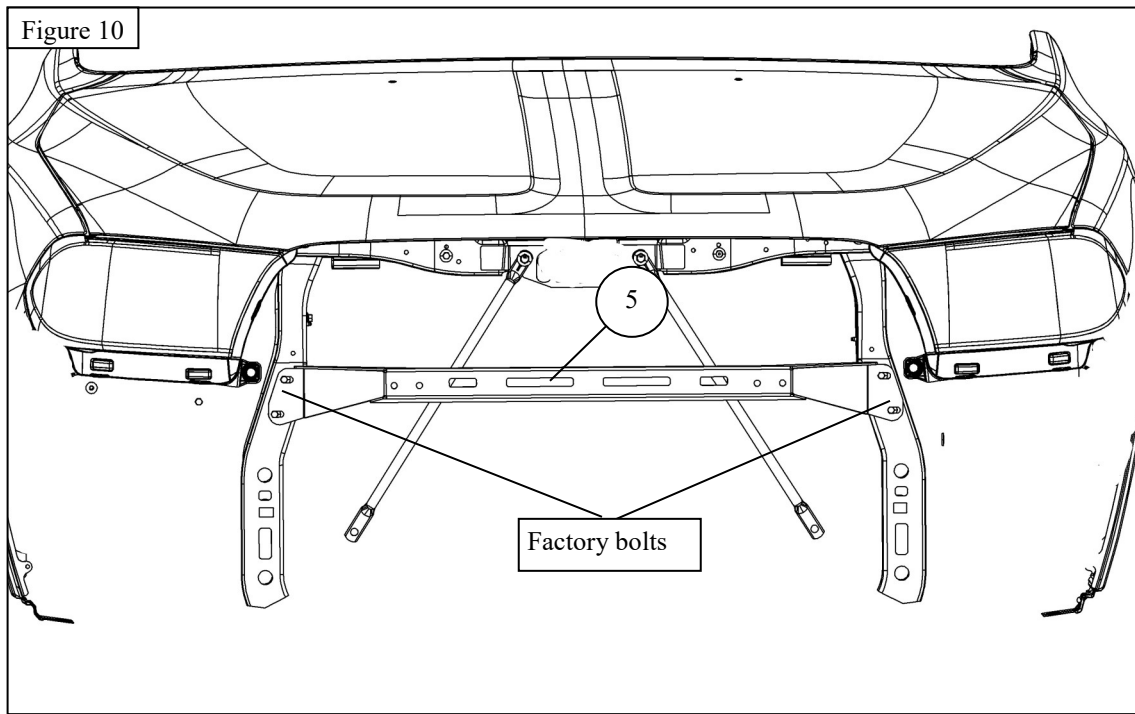

10. After assembling all brackets (except straps), use M12 hardware to test fit the Push Bumper on the vehicle without the fascia. Adjust as needed and tighten all the brackets to the vehicle as specified: M8 to 15-18 ft.-lbs. See **Figure 11**
11. After test fit, remove the push bumper.

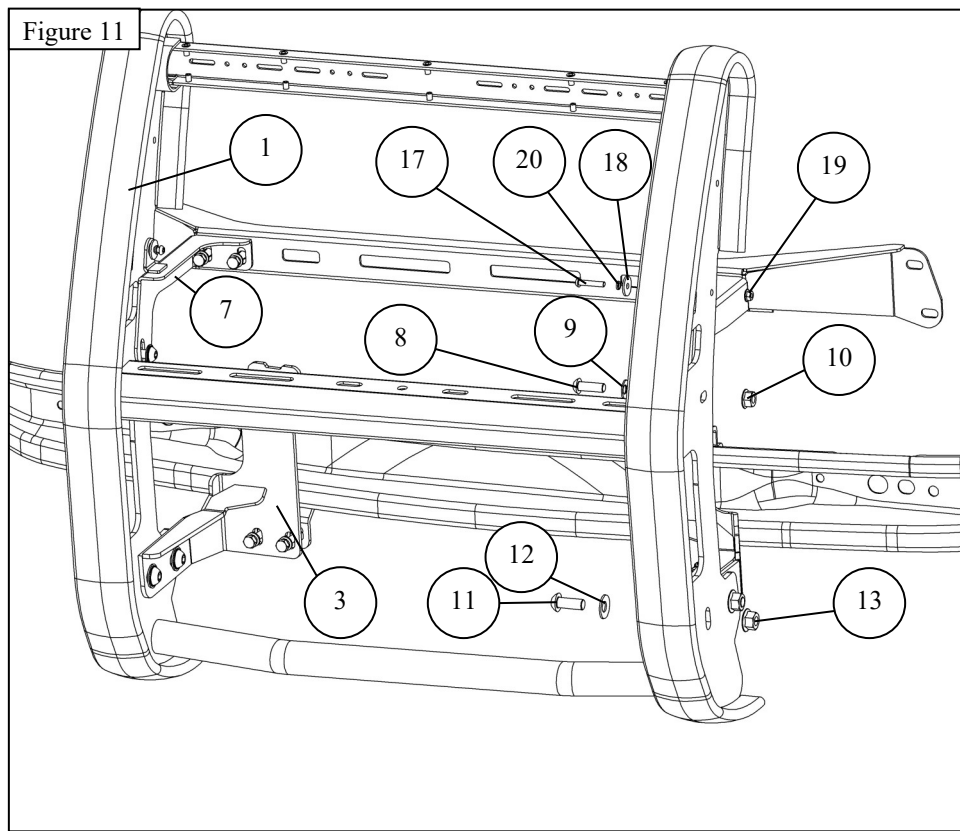

13. Replace the trimmed radiator corner shrouds and reinstall the grille in the fascia. Plug in the running lights as well. Replace the fascia on the vehicle over the installed brackets. Ensure every bracket has clearance.
14. Using supplied M8 hardware, loosely assemble the support straps (6 & 7) to the cross bar. Repeat on the passenger side **See Figure 11-12 & 13**
15. Re-install the push bumper using M12 hardware at the bottom brackets, at the middle M10 and at the top M6. **Figure 13.** Torque hardware as specified:
M6 to 7-8 ft. lbs. M8 to 15-18 ft. lbs, M10 to 35-38 ft. lbs, M12 to 55-58 ft. lbs.

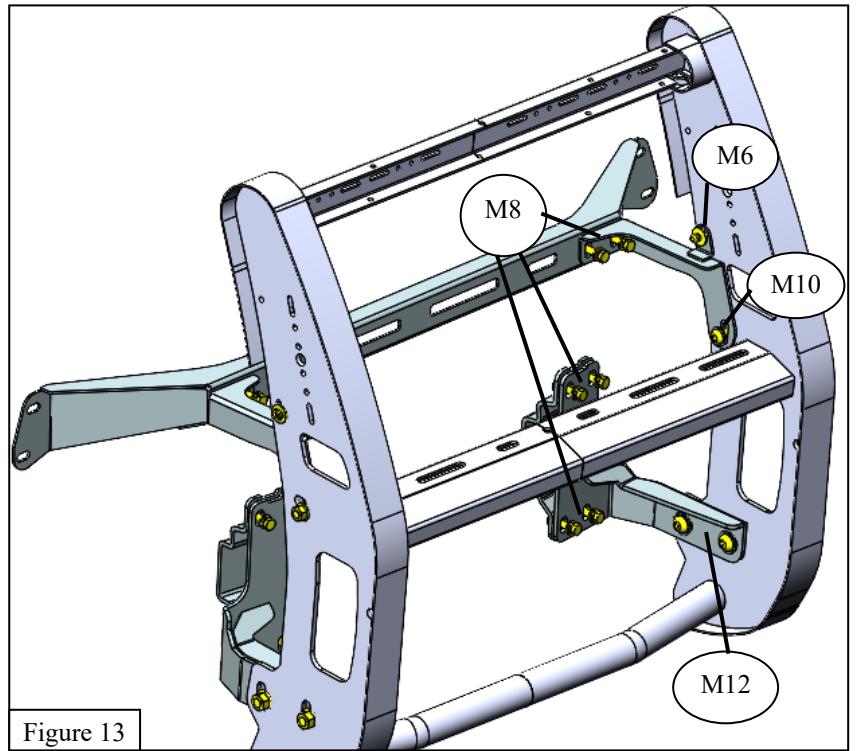
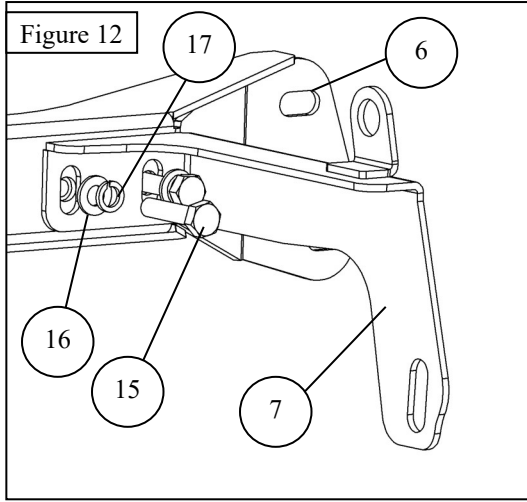

CARE INSTRUCTIONS

- REGULAR WAXING IS RECOMMENDED. DO NOT USE ANY TYPE OF POLISH OR WAX THAT MAY CONTAIN ABRASIVES.
- STAINLESS STEEL PRODUCTS CAN BE CLEANED WITH MILD SOAP AND WATER. STAINLESS STEEL POLISH SHOULD BE USED TO POLISH SMALL SCRATCHES.
- GLOSS BLACK FINISHES SHOULD BE CLEANED WITH MILD SOAP AND WATER.

WESTIN Westin Automotive Products, Inc.
320 W. Covina Blvd
San Dimas, Ca. 91773

Thank you for choosing Westin products
for additional installation assistance please call
Customer Service (800) 793-7846

www.westinautomotive.com

DATE: 8/5/2020



WARNING



Failure to follow these instructions could lead to death, personal injury, and / or property damage.

FASTENERS:

All Westin supplied fasteners must be utilized and installed in accordance with the installation instructions and apply torque to the specifications as defined. **DOUBLE CHECK ALL FASTENERS BEFORE INITIAL USE, AND PERIODICALLY IN THE FUTURE TO ENSURE PROPER FUNCTION AND SAFETY.**

DRILLING:

Most Westin products do not require drilling for installation. If drilling is defined as required, use caution when drilling a vehicle. **FAILURE TO REVIEW AN AREA TO BE DRILLED MAY RESULT IN PERSONAL INJURY AND/OR INJURY TO OTHERS AS WELL AS VEHICLE DAMAGE.**

EYE PROTECTION:

ALWAYS WEAR SAFETY GLASSES OR GOGGLES DURING THE INSTALLATION PROCESS TO AVOID PERSONAL INJURY.

MAXIMUM TOWING/CARRYING CAPACITY: (if applicable)

The Westin Receiver Hitches will have a visible tow rating label affixed directly on the product. User should never exceed the vehicle manufacturers maximum tow and weight rating regardless of the capacity of the hitch. **FAILURE TO FOLLOW THESE GUIDELINES WILL VOID THE WESTIN WARRANTY AND MAY RESULT IN PERSONAL INJURY AND/OR INJURY TO OTHERS AS WELL AS VEHICLE DAMAGE.**

FOR CALIFORNIA RESIDENTS ONLY-PROP 65 WARNING:

Some products may contain chemicals such as DEHP, which can cause cancer, birth defects or other reproductive harm. For more info go to www.p65warnings.ca.gov



Westin Automotive Products, Inc.
320 W. Covina Blvd
San Dimas, Ca. 91773